

SCALE 1:2,000

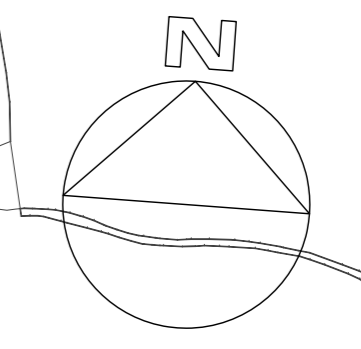

NOTES

- DO NOT SCALE FROM THIS DRAWING.
- ALL MEASUREMENTS ARE IN METRES UNLESS STATED OTHERWISE.
- BASE PLAN IS OS MASTERMAP WITH MINOR MODIFICATIONS BY ATKINS

KEY:

- PLANNING APPLICATION RED LINE
- PLANNING AUTHORITY BOUNDARY LINE
- DEVON COUNTY COUNCIL AUTHORITY (AREA OUTSIDE DARTMOOR NATIONAL PARK JURISDICTION)
- LAND IN CONTROL OF THE APPLICANT
- EXISTING ACCESS TO QUARRY

THE RED LINE HAS BEEN DRAWN TO ENCLOSE THE FOLLOWING WITH A 5M MARGIN:

- EXISTING QUARRY, WORKSHOP AREA, TIP AND BUNDS
- PROPOSED QUARRY EXTENSION AND SURROUNDING BUNDS AND TIP
- CLOSURE OF ALSTON LANE JUNCTION
- ACCESSES TO PLACE HOUSE, AND TO WAYE HOUSE AND FARM
- ACCESS TO ALSTON FARM COTTAGE
- WIDENING OF BALLAND LANE AND ALTERATIONS TO COACH TURNING CIRCLE
- SURFACE WATER MANAGEMENT
- BALLAND CATCHMENT ATTENUATION WORKS
- TRANSLOCATED HEDGEROWS AND NEW HEDGEROW PLANTING
- NEW WOODLAND BLOCK PLANTING

SEE DRAWING 'LINHAY-ATK-STAGED-ZZ-PL-T-0002 SITE PLAN - PROPOSED' FOR PROPOSED EXTENT OF THESE WORKS.

Part of the application site which falls under Dartmoor National Park Authority

Parts of the application site which fall under Devon County Council Authority

SCALE 1:10,000

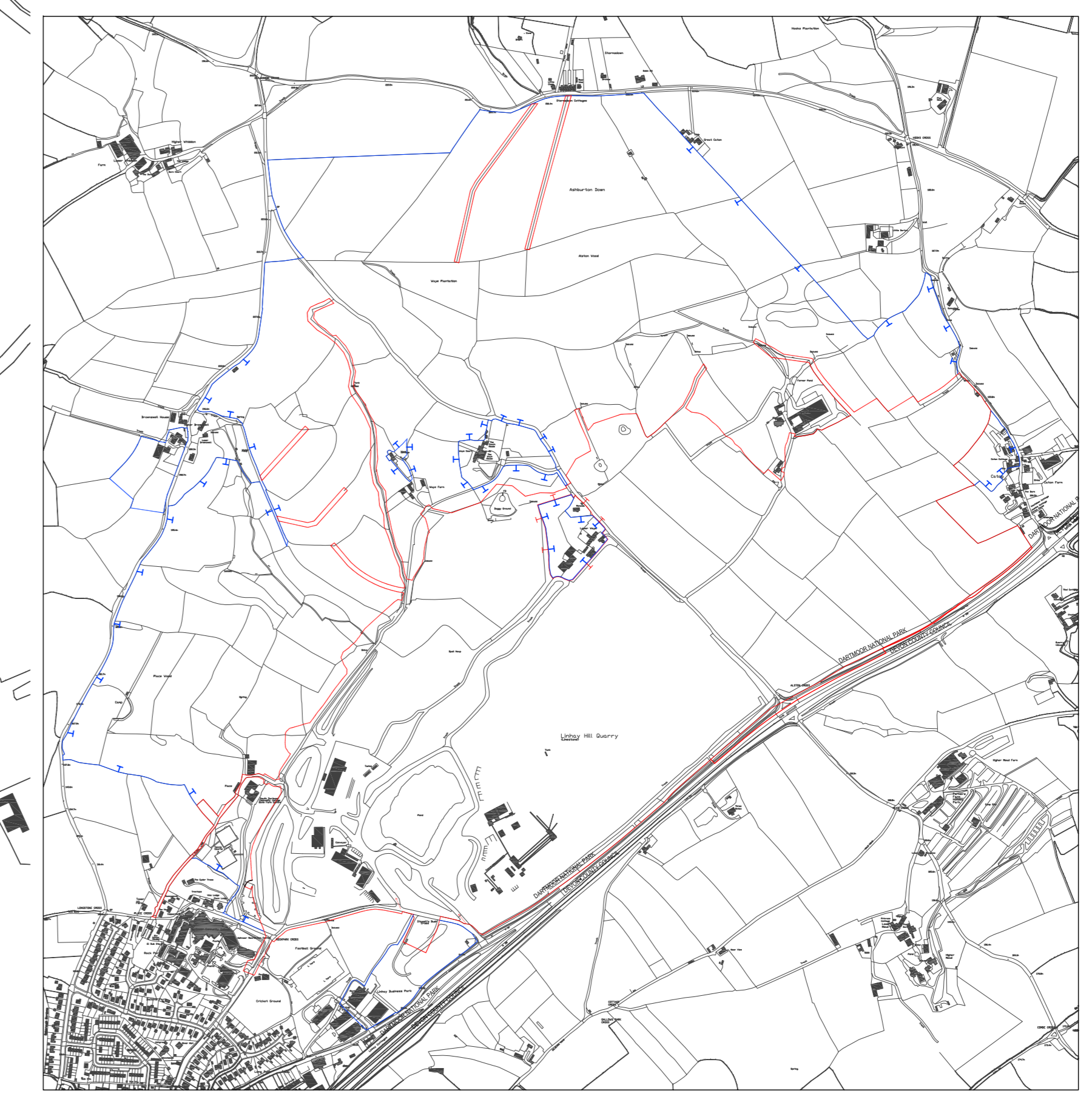

Rev	Date	Description	By	Checked	App'd

FOR PLANNING S0

ATKINS
 Atkins Limited
 The Octagon
 Pynes Hill Court
 Rydon Lane
 Exeter
 EX2 5AZ
 Telephone: +44(0)1392 322900
 Fax: +44(0)1392 302999
 www.atkinsglobal.com



Project Title
LINHAY HILL QUARRY PROPOSED EXTENSION

Drawing Title
SITE PLAN - EXISTING

Scale	Designed	Drawn	Checked	Authorised
As shown	AH	SSM	ATF	AH
Original Size	Date	Date	Date	Date
A0	09.11.15	09.11.15	09.11.15	09.11.15
Drawing Number	Revision			Revision
LINHAY-ATK-GEN-T-PL-0001				P4